

| | | | | | | |
|----|-------|----|------|----|------|----|
| | 12,50 | | | | | |
| 25 | 3,75 | 20 | 8,05 | | | 25 |
| 25 | 2,43 | 25 | 1,07 | 20 | 8,05 | 25 |

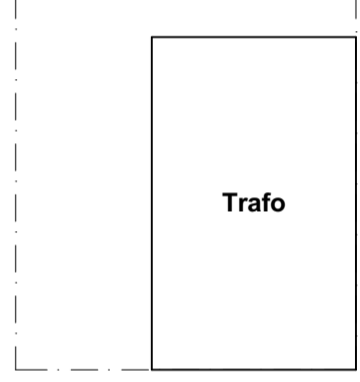
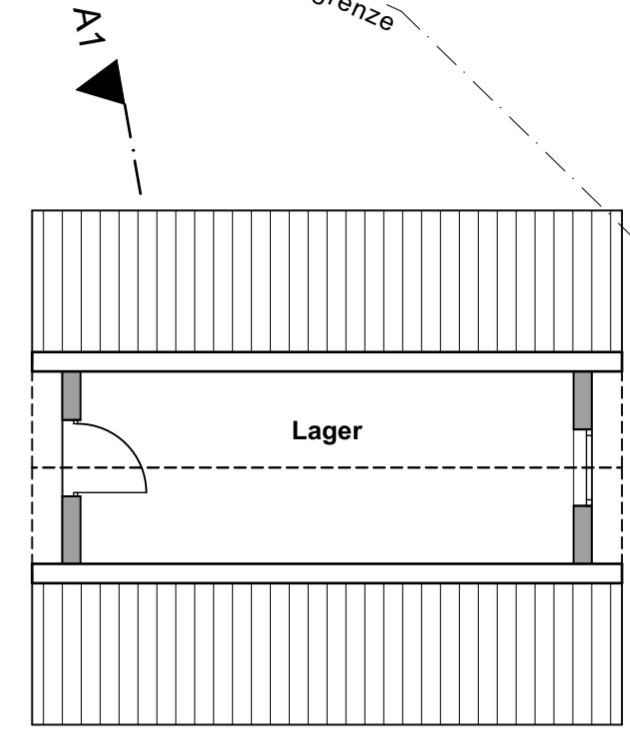
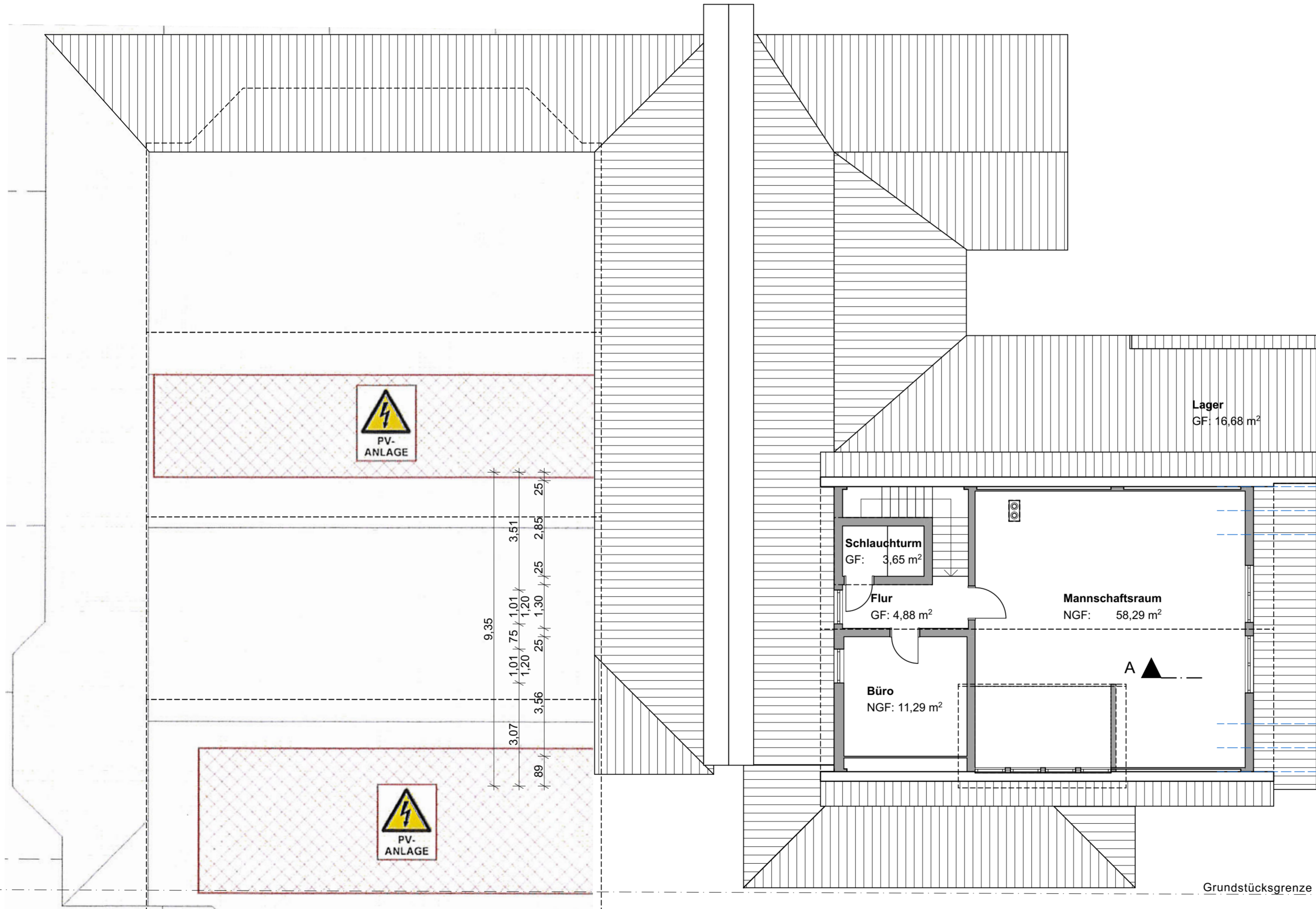

| | | | |
|--|-------------------|------|------|
| | 3,68 | | 3,68 |
| | 56 | 1,16 | 80 |
| | 2,77 ^s | 1,20 | 90 |
| | 8,24 | 1,70 | 1,72 |
| | 40 | 1,20 | 3,68 |
| | 2,77 ^s | 1,20 | 9,35 |
| | 55 | 1,70 | |
| | 2,77 ^s | 1,20 | |
| | 1,00 m | | |
| | 1,50 m | | |
| | 2,00 m | | |
| | 2,00 m | | |
| | 1,50 m | | |
| | 1,00 m | | |

| | | | | | | |
|----|------|----|-----------------|----|-----------------|------|
| 29 | 3,67 | 24 | 8,05 | | | 25 |
| | 3,96 | | 4,44 | | | 4,10 |
| | 3,96 | 24 | 15 ^s | 14 | 15 ^s | 15 |
| | | | 90 | 90 | 90 | 90 |

-Bestandserfassung-

BAUVORHABEN:
Erweiterung Feuerwehrrätehaus Born
 Mühlenbergstraße 21, 65329 Hohenstein-Born
 Gemarkung: Born, Flur: ____, Flurstück: ____

BAUHERR:
Gemeindevorstand der Gemeinde Hohenstein
 Schwalbacher Straße 1, 65329 Hohenstein

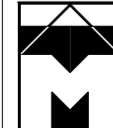
PLANVERFASSEN:

Architekturbüro Trimper & Massold PartG mbB
 Martin - Luther - Straße 1, 65307 Bad Schwalbach
 Tel. (0 61 24) 1 28 96 - Fax: (0 61 24) 44 15

GEZEICHNET: Datum: 02.04.2020 Name: TD

PLANART: GR Obergeschoss_Bestand MAßSTAB: 1:100 NR.: 02